

---

# SECTION 8A

## SEAT BELTS

**CAUTION:** *Disconnect the negative battery cable before removing or installing any electrical unit or when a tool or equipment could easily come in contact with exposed electrical terminals. Disconnecting this cable will help prevent personal injury and damage to the vehicle. The ignition must also be in B unless otherwise noted.*

### TABLE OF CONTENTS

<b>Description and Operation</b> .....	<b>8A-2</b>	<b>Repair Instructions</b> .....	<b>8A-5</b>
Driver Seat Belt Warning .....	8A-2	On-Vehicle Service .....	8A-5
Three-Point Pretensioner Front Seat Belt (W/EUROPE Only) .....	8A-2	Three-Point WLR/ELR Front Seat Belt .....	8A-5
Three-Point WLR Front Seat Belt .....	8A-2	Three-Point Pretensioner Front Seat Belt (W/EUROPE Only) .....	8A-6
Three-Point ELR Front Seat Belt .....	8A-2	Front Seat Belt Buckle .....	8A-8
Three-Point ELR Rear Outboard Seat Belt ....	8A-2	Three-Point ELR Rear Outboard Seat Belt ...	8A-8
Two-Point Lap Rear Center Seat Belt .....	8A-2	Two-Point Lap Rear Center Seat Belt .....	8A-10
Operational and Functional Checks .....	8A-2	<b>Specifications</b> .....	<b>8A-11</b>
<b>Component Locator</b> .....	<b>8A-3</b>	Fastener Tightening Specifications .....	8A-11
Front and Rear Seat Belt .....	8A-3	<b>Schematic and Routing Diagrams</b> .....	<b>8A-12</b>
<b>Diagnostic Information and Procedures</b> .....	<b>8A-4</b>	Driver Seat Belt Warning .....	8A-12
Seat Belt Warning Lamp is Inoperative .....	8A-4		

## DESCRIPTION AND OPERATION

### DRIVER SEAT BELT WARNING

The driver's safety belt incorporates a safety belt reminder light in the instrument cluster to remind the driver if the safety belt is not fastened when the ignition is turned ON.

### THREE-POINT PRETENSIONER FRONT SEAT BELT (W/EUROPE ONLY)

The pretensioner front seat belt is optional. It contains a electrically-controlled pyrotechnical retractor, which reduces seat belt slack when it is activated in a head-on or angled front collision. The pretensioner front seat belt must be replaced after an accident that causes its activation.

### THREE-POINT WLR FRONT SEAT BELT

The three-point web locking retractor (WLR) seat belt will limit the movement of the driver and offer better protection in an accident.

### THREE-POINT ELR FRONT SEAT BELT

The three-point emergency locking retractor (ELR) front seat belt is always unlocked, allowing the passenger freedom of movement, except in emergencies (rapid deceleration, rapid acceleration, or hard cornering maneuvers).

### THREE-POINT ELR REAR OUTBOARD SEAT BELT

The rear outboard seating positions use the three-point emergency locking retractor (ELR) seat belts. The three-point emergency locking retractor (ELR) seat belt

is always unlocked, allowing the passenger freedom of movement, except in emergencies (rapid deceleration, rapid acceleration, or hard cornering maneuvers).

### TWO-POINT LAP REAR CENTER SEAT BELT

The two-point lap rear center seat belt is a single continuous length of webbing. The webbing is routed from the anchor through a latch plate and into a single retractor.

### OPERATIONAL AND FUNCTIONAL CHECKS

#### **Caution:**

- **Keep sharp objects and potentially damaging objects away from the seat belts.**
  - **Avoid bending or damaging any portion of the buckle or the latch plate.**
  - **Do not bleach or dye the belt webbing. Use only mild soap and water in order to clean the belts.**
  - **When installing the seat belt anchor bolts and the screws, start the bolts and the screws by hand in order to prevent crossthreading.**
  - **Do not attempt any repairs on the retractor mechanisms or the covers. Replace any defective assemblies with new assemblies.**
  - **Replace any belts that are cut or damaged in any way.**
1. Inspect all seat belt anchor bolts and the screws in order to verify that they are secure.
  2. Inspect the seat belt buckle. The buckle must lock and unlock easily.
  3. After inserting the latch into the buckle, tug sharply on the belt. The buckle must remain locked.
  4. Fully extend the shoulder belt portion to make sure that there is no twisting or tears in the belt.
  5. Let the shoulder belt retract fully. The belt should retract easily.

# COMPONENT LOCATOR

## FRONT AND REAR SEAT BELT

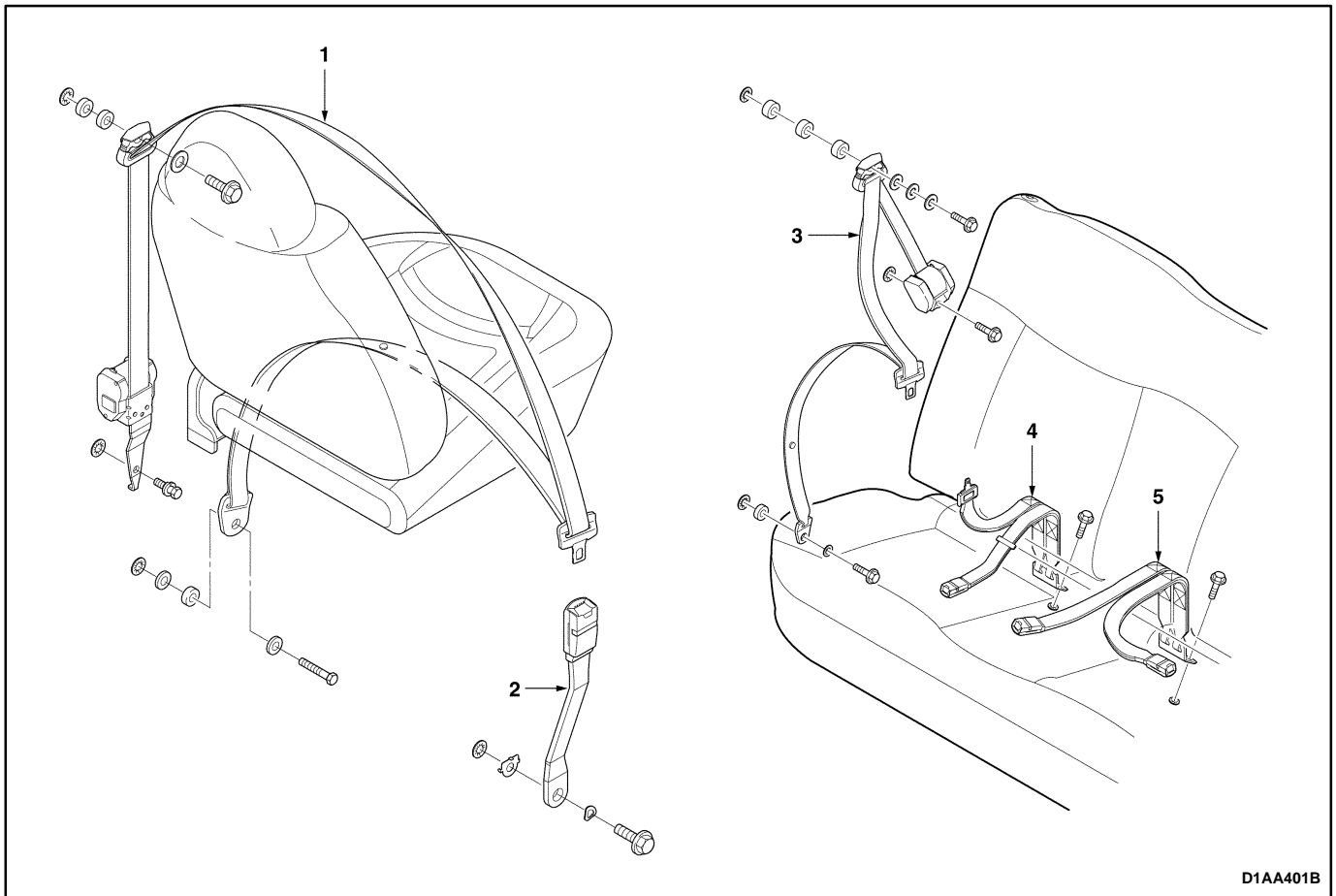

D1AA401B

1. Front Seat Belt
2. Front Seat Belt Buckle
3. Rear Seat Belt (Three-Point)
4. Rear Seat Belt (Two-Point) / Buckle (Three-Point)
5. Rear Seat Belt Buckle (Three-Point/Two-Point)

**DIAGNOSTIC INFORMATION AND PROCEDURES****SEAT BELT WARNING LAMP IS INOPERATIVE**

<b>Condition</b>	<b>Probable Cause</b>	<b>Correction</b>
Seat Belt Warning Lamp is Inoperative	<ul style="list-style-type: none"><li>● Fuse F1 is blown.</li></ul>	<ul style="list-style-type: none"><li>● Replace the fuse F1.</li></ul>
	<ul style="list-style-type: none"><li>● Seat belt warning lamp wiring harness is open circuit or a short circuit.</li></ul>	<ul style="list-style-type: none"><li>● Repair the wiring harness.</li></ul>
	<ul style="list-style-type: none"><li>● The continuity between the two terminals at the switch side of the connector is fail.</li></ul>	<ul style="list-style-type: none"><li>● Replace the seat belt switch.</li></ul>
	<ul style="list-style-type: none"><li>● The continuity between the terminal for the BLK wire and ground is fail.</li></ul>	<ul style="list-style-type: none"><li>● Repair the open ground.</li></ul>
	<ul style="list-style-type: none"><li>● The warning lamp bulb in the instrument cluster is blown.</li></ul>	<ul style="list-style-type: none"><li>● Replace the warning lamp bulb.</li></ul>

# REPAIR INSTRUCTIONS

## ON-VEHICLE SERVICE

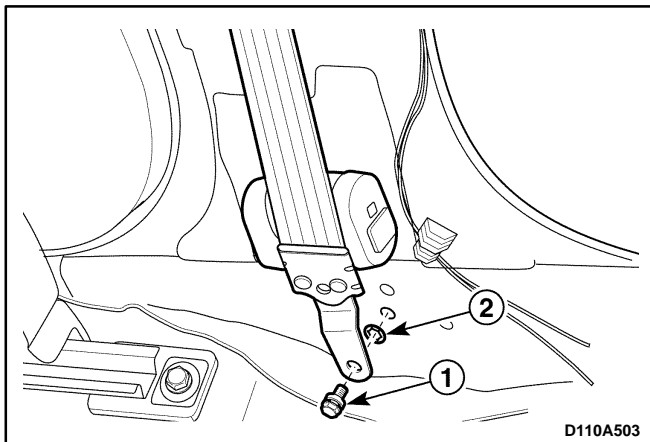
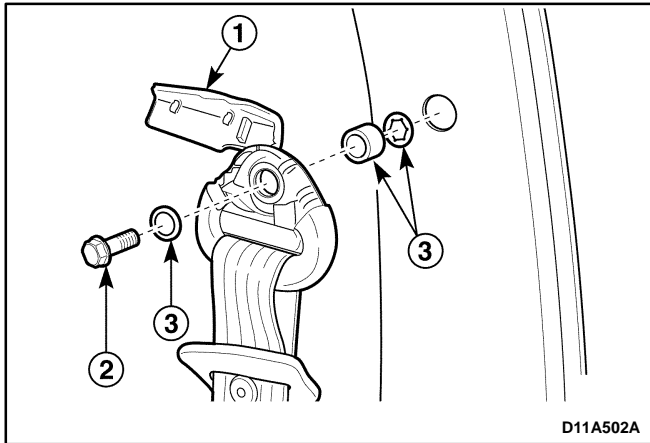
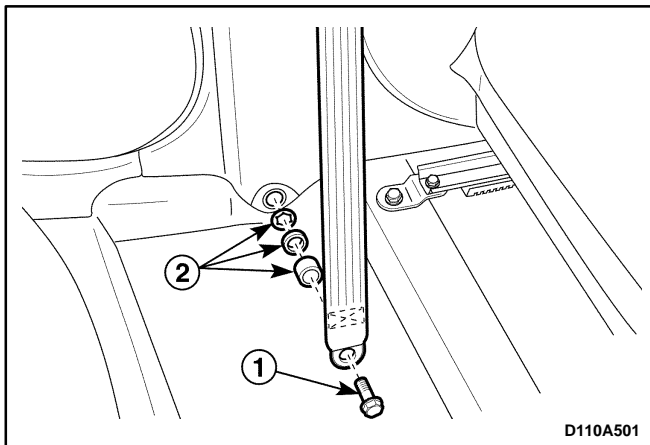

### THREE-POINT WLR/ELR FRONT SEAT BELT

#### Removal Procedure

1. Slide the front seat forward and fold the seatback.
2. Remove the bolt on the lower B-pillar.
  - Remove the bolt (1).
  - Remove the spacer and the fiber washer (2).
  - Remove the plastic protector on the seat belt anchor.
3. Remove the lower B-pillar trim panel. Refer to *Section 9G, Interior Trim*.
4. Remove the bolt on the upper B-pillar.
  - Using a flathead screwdriver, open the bolt cap (1).
  - Remove the bolt (2).
  - Remove the spacer and the fiber washer (3).
5. Remove the seat belt retractor bolt.
  - Remove the floor carpet to be seen the retractor.
  - Remove the bolt (1).
  - Remove the fiber washer (2).
  - Remove the seat belt retractor.

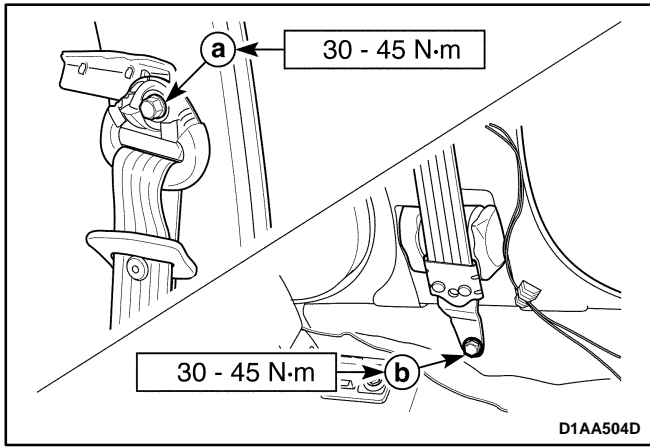

### Installation Procedure

**Notice:** Dissimilar metals in direct contact with each other may corrode rapidly. Make sure to use the correct fasteners to prevent premature corrosion.

1. Install in the reverse order of removal.
2. Install the bolt on the upper B-pillar.

#### Tighten

Tighten the seat belt upper bolt to 30–45 N•m (22–33 lb-ft).

- a. Seat belt upper bolt.

3. Install the seat belt retractor with the bolt.

#### Tighten

Tighten the seat belt retractor bolt to 30–45 N•m (22–33 lb-ft).

- b. Seat belt retractor bolt.

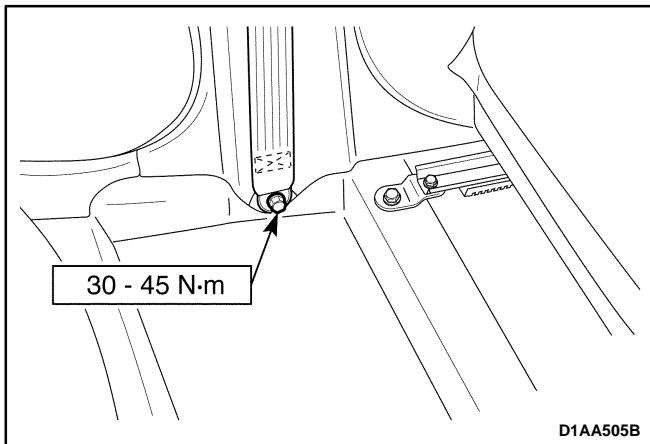

4. Install the bolt on the lower B-pillar.

- Install the bolt.

#### Tighten

Tighten the lower B-pillar bolt to 30–45 N•m (22–33 lb-ft).

- Install the spacers and the spring washer.
- Install the plastic protector on the seat belt anchor.

5. Relocate the seatback.

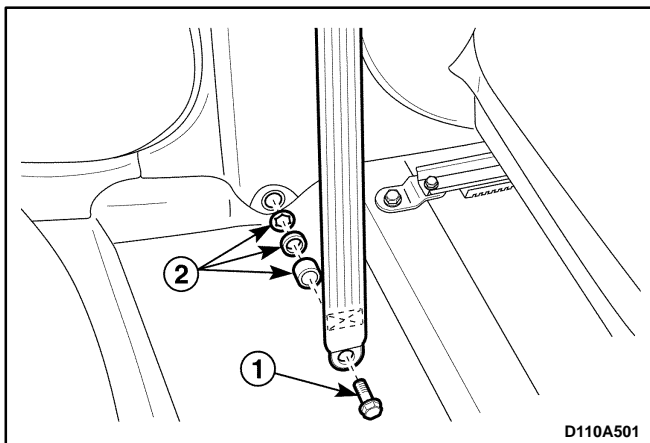

### THREE-POINT PRETENSIONER FRONT SEAT BELT (W/EUROPE ONLY)

#### Removal Procedure

1. Slide the front seat forward and fold the seatback.
2. Remove the bolt on the lower B-pillar.

- Remove the bolt (1).
- Remove the spacer and the fiber washer (2).
- Remove the plastic protector on the seat belt anchor.

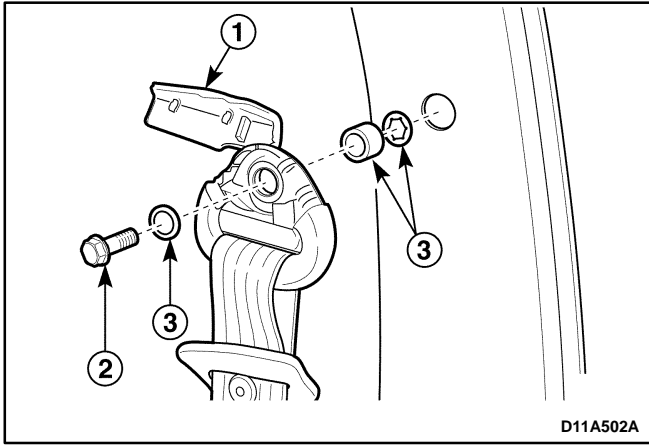

3. Remove the lower B-pillar trim panel. Refer to Section 9G, Interior Trim.
4. Remove the bolt on the upper B-pillar.
  - Using a flathead screwdriver, open the bolt cap (1).
  - Remove the bolt (2).
  - Remove the spacer and the fiber washer (3).

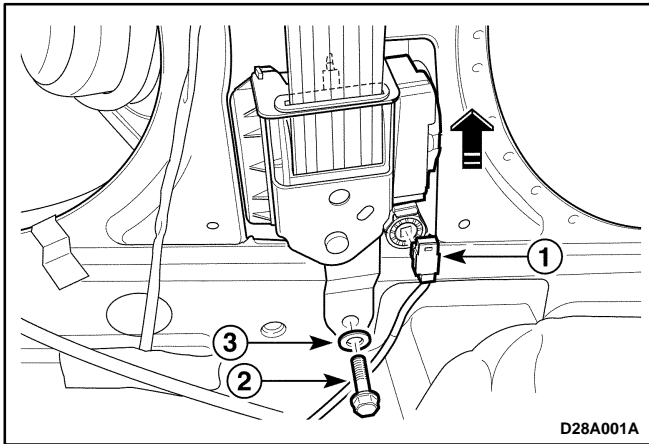

5. Remove the seat belt retractor bolts.
  - Remove the floor carpet to be seen the retractor.
  - Disconnect the pretensioner front seat belt connector (1).
  - Remove the lower retractor bolt (2).
  - Remove the fiber washer (3).
  - Remove the seat belt retractor.

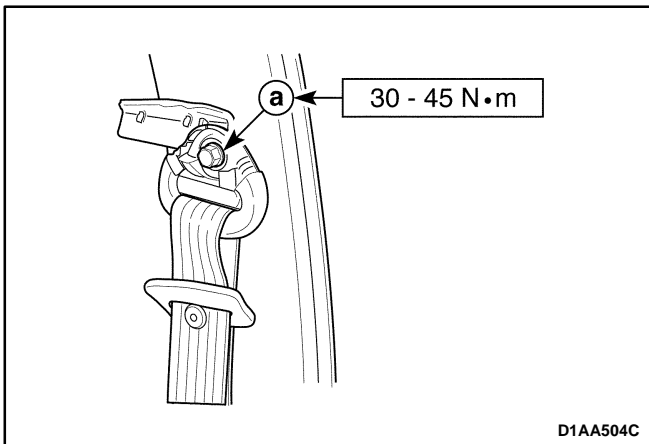

### Installation Procedure

**Notice:** Dissimilar metals in direct contact with each other may corrode rapidly. Make sure to use the correct fasteners to prevent premature corrosion.

1. Install in the reverse order of removal.
2. Install the bolt on the upper B-pillar.

#### Tighten

Tighten the seat belt upper bolt to 30–45 N•m (22–33 lb-ft).

- a. Seat belt upper bolt.

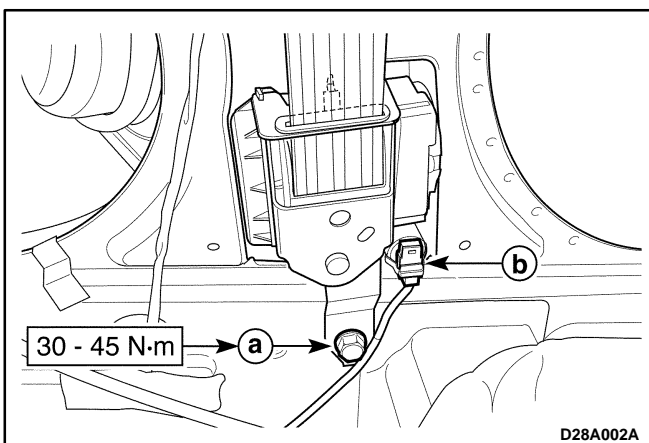

3. Install the seat belt retractor with the bolt.

#### Tighten

- Tighten the lower retractor bolt to 30–45 N•m (22–33 lb-ft).

- a. Lower retractor bolt.
- b. Connect the pretensioner front seat belt connector.

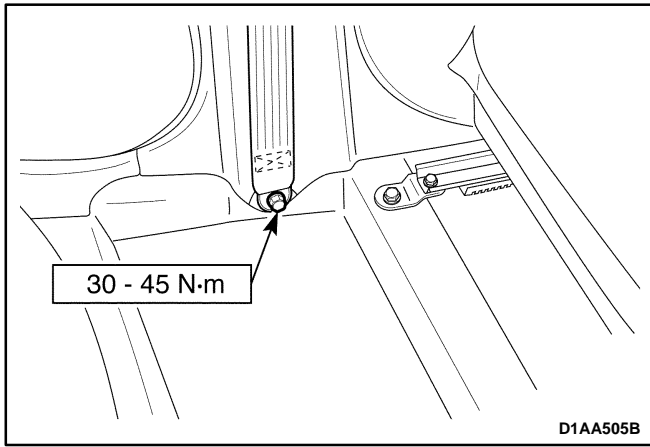

4. Install the bolt on the lower B-pillar.

- Install the bolt.

### Tighten

Tighten the lower B-pillar bolt to 30–45 N•m (22–33 lb-ft).

- Install the spacers and the fiber washer.
- Install the plastic protector on the seat belt anchor.

5. Relocate the seatback.

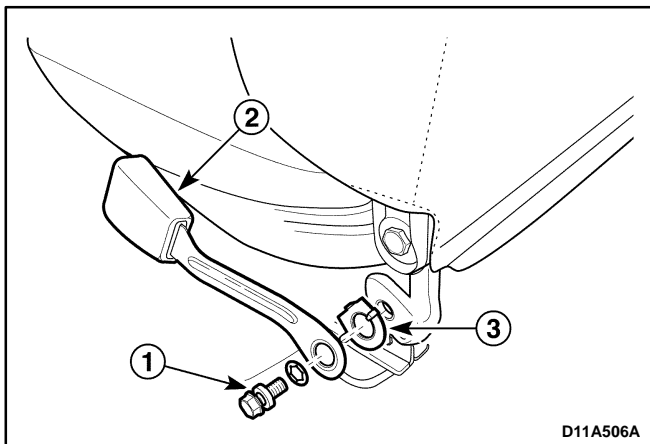

## FRONT SEAT BELT BUCKLE

### Removal Procedure

1. Remove the front seat belt buckle

- Remove the bolt (1).
- Remove the buckle (2).
- Remove the patch (3).
- Before removing the driver seat belt buckle, disconnect the reminder light connector.

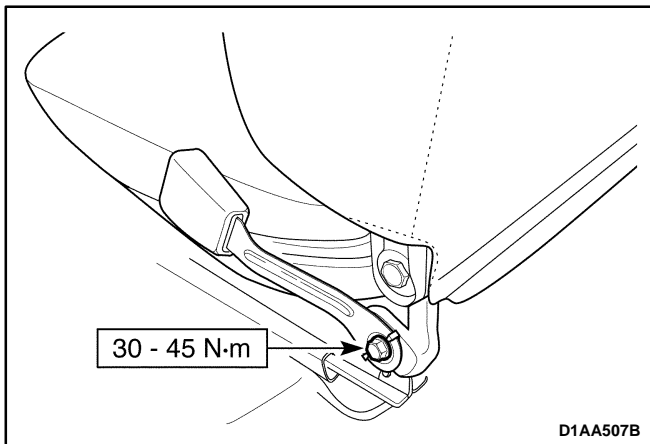

### Installation Procedure

1. Install the front seat belt buckle.

- Connect the reminder light connector.
- Install the patch.
- Install the buckle.
- Install the bolt.

### Tighten

Tighten the seat belt buckle bolt to 30–45 N•m (22–33 lb-ft).

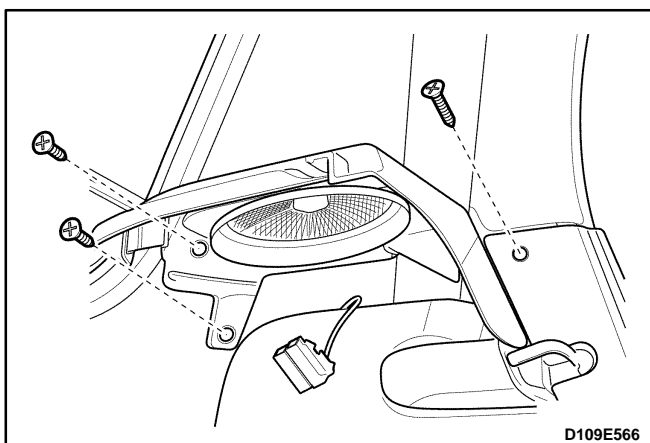

## THREE-POINT ELR REAR OUTBOARD SEAT BELT

### Removal Procedure

1. Remove the rear seat cushion and the rear seatback.
2. Pry off the rear interior trim panel. Refer to *Section 9G, Interior Trim*.
  - Pry off the backshelf trim panel.
  - Pry off the luggage compartment side load trim panel.



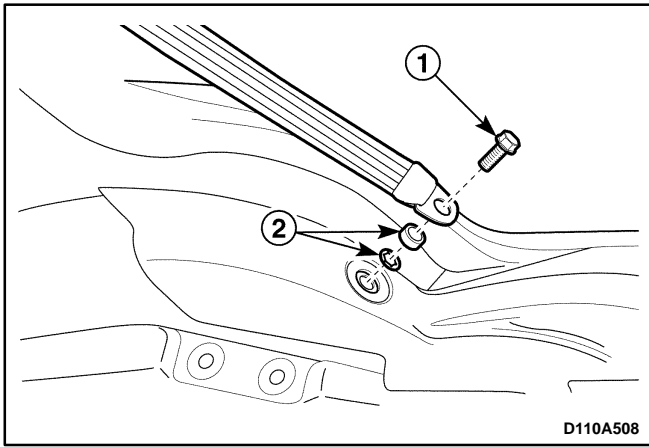

3. Remove the bolt on the floor.
  - Remove the bolt (1).
  - Remove the spacer and the fiber washer (2).
  - Remove the plastic protector on the seat belt anchor.

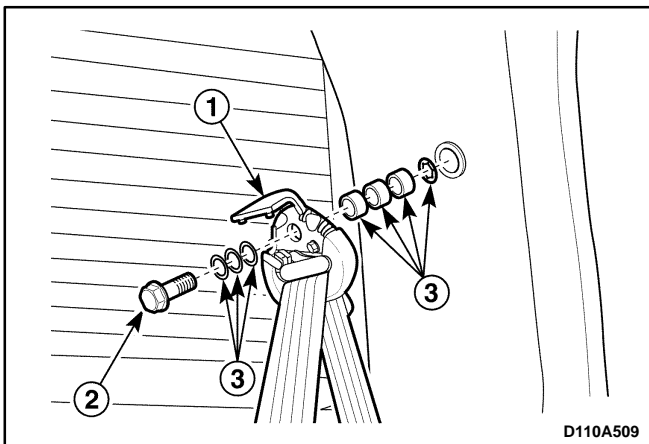

4. Pry off the luggage compartment trim panel. Refer to section 9G, *Interior Trim*.
5. Remove the bolt on the C-pillar trim panel (1).
  - Open the bolt cap using a flathead screw driver.
  - Remove the bolt (2).
  - Remove the plastic washers, the spacers and the fiber washer (3).

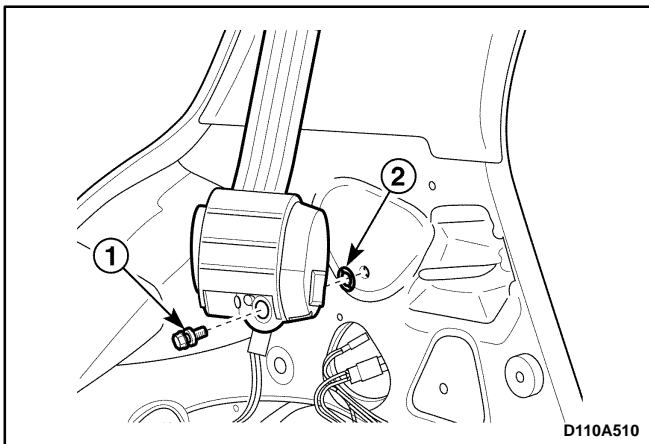

6. Remove the seat belt retractor bolt.
  - Remove the bolt (1).
  - Remove the fiber washer (2).
  - Remove the rear seat belt.

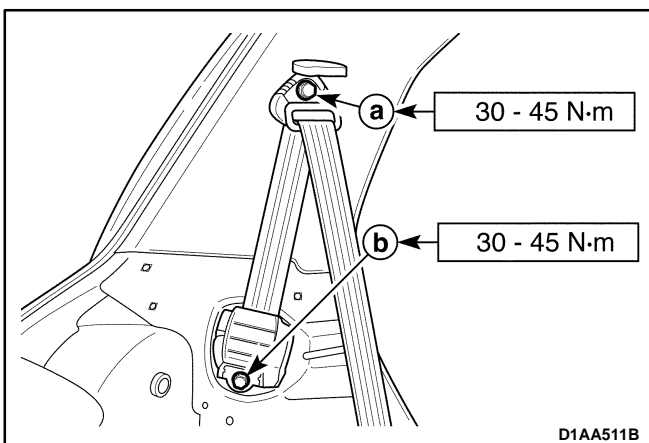

### Installation Procedure

1. Install in the reverse order of removal.
2. Install the seat belt retractor bolt and the upper bolt.

#### Tighten

- Tighten the seat belt upper bolt to 30–45 N•m (22–33 lb-ft).
  - a. Seat belt upper bolt.
- Tighten the seat belt retractor bolt to 30–45 N•m (22–33 lb-ft).
  - b. Retractor bolt.

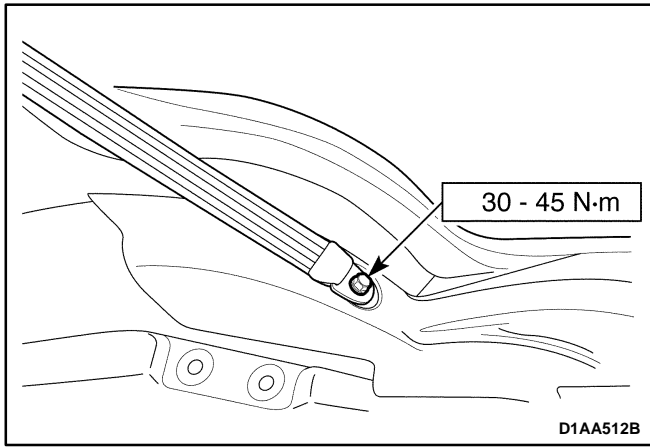

3. Install the bolt on the floor.

**Tighten**

Tighten the bolt on the floor to 30–45 N•m (22–33 lb-ft).

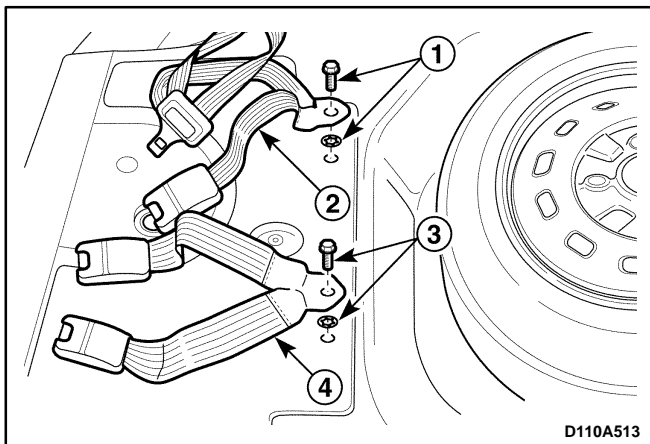

**TWO-POINT LAB REAR CENTER SEAT BELT**

**Removal Procedure**

1. Remove the rear seat cushion.
2. Remove the two-point rear seat belt and the buckle.
  - Remove the bolt and the fiber washer (1).
  - Remove the seat belt (two-point) and the buckle (three-point) (2).
  - Remove the bolt and the fiber washer (3).
  - Remove the buckle (two-point and three-point) (4).

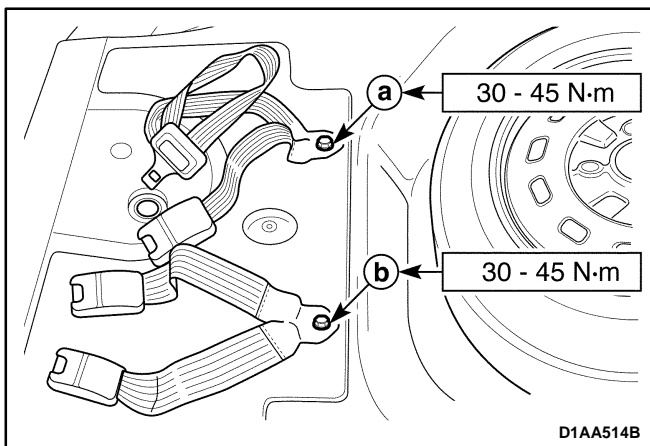

**Installation Procedure**

1. Install in the reverse order of removal.
2. Install the three-point rear seat belt buckle with the bolt.

**Tighten**

Tighten the three-point rear seat belt buckle bolt and the two-point rear seat belt bolt to 30–45 N•m (22–33 lb-ft).

- a. Two-point rear seat belt and three-point rear seat belt buckle bolt.
3. Install the two-point rear seat belt with the bolt.

**Tighten**

Tighten the two-point and three-point rear seat belt buckle bolt to 30–45 N•m (22–33 lb-ft).

- b. Two-point and three-point rear seat belt buckle bolt.

# SPECIFICATIONS

## FASTENER TIGHTENING SPECIFICATIONS

<b>Application</b>	<b>N•m</b>	<b>Lb-Ft</b>	<b>Lb-In</b>
Seat Belt Upper Bolt	30 – 45	22 – 33	–
Seat Belt Lower Bolt	30 – 45	22 – 33	–
Seat Belt Retractor Bolt	30 – 45	22 – 33	–
Seat Belt Buckle Bolt	30 – 45	22 – 33	–
Rear Seat Belt Buckle Bolt	30 – 45	22 – 33	–

# SCHEMATIC AND ROUTING DIAGRAMS

## DRIVER SEAT BELT WARNING

