SECTION 4G

PARKING BRAKE

TABLE OF CONTENTS

Description and Operation	4G-2	Parking Brake Warning Lamp Switch	4G-5
Parking Brake	4G-2	Parking Brake Cable	4G-6
Component Locator	4G-3	Specifications	4G-8
Parking Brake	4G-3	General Specifications	4G-8
Repair Instructions	4G-4	Fastener Tightening Specifications	4G-8
On-Vehicle Service	4G-4	Schematic and Routing Diagrams	4G-9
Parking Brake Lever	4G-4	Parking Brake System	4G-9

DESCRIPTION AND OPERATION

PARKING BRAKE

This braking system uses a BRAKE warning light located in the instrument panel cluster. When the ignition switch is in the III position, the BRAKE warning light should glow and go OFF when the parking brake lever is released. Whenever the parking brake is applied and the

ignition switch is II, the BRAKE warning light should glow.

When the brake is firmly applied, the parking brake should securely hold the vehicle with ample pedal travel remaining. Check for frayed cables, rust, etc., or any condition that may inhibit present (or future) free movement of the parking brake lever assembly.

COMPONENT LOCATOR

PARKING BRAKE

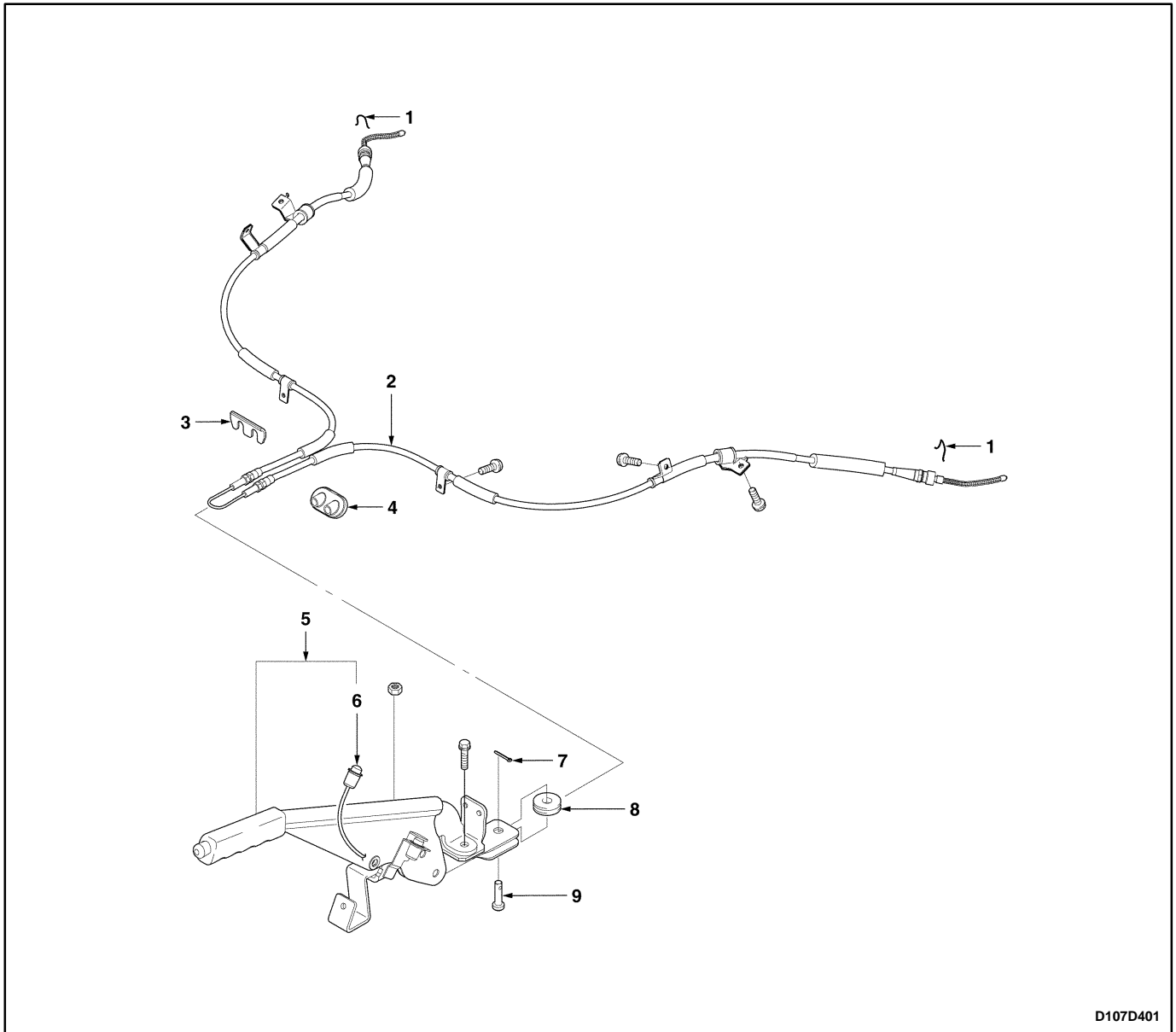

D107D401

- | | |
|---------------------------------|--------------------------------------|
| 1. Parking Brake Cable Clip | 6. Parking Brake Warning Lamp Switch |
| 2. Parking Brake Cable | 7. Cotter Pin |
| 3. Strengthener | 8. Cable Pulley |
| 4. Cable Grommet | 9. Pin |
| 5. Parking Brake Lever Assembly | |

REPAIR INSTRUCTIONS

ON-VEHICLE SERVICE

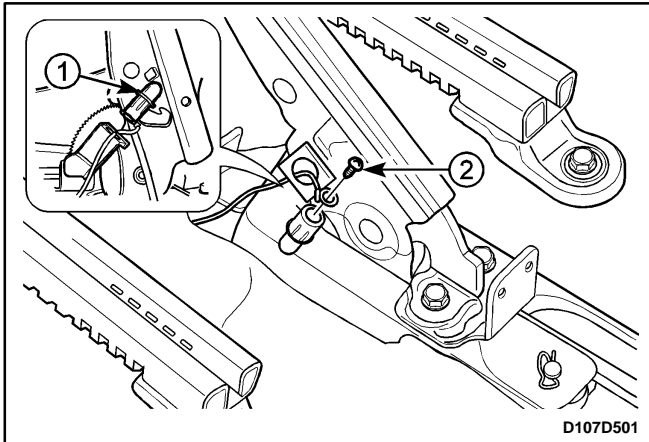

PARKING BRAKE LEVER

Removal Procedure

1. Remove the parking brake lever cover. Refer to Section 9G, Interior Trim.
2. Remove the parking brake cable cover. Refer to Section 9G, Interior Trim.
3. Remove the parking brake lever.
 - Disconnect the brake warning lamp switch (1).
 - Remove the brake warning switch lamp screw (2).

Important: The brake warning lamp switch screw should be removed with the lever fixed.

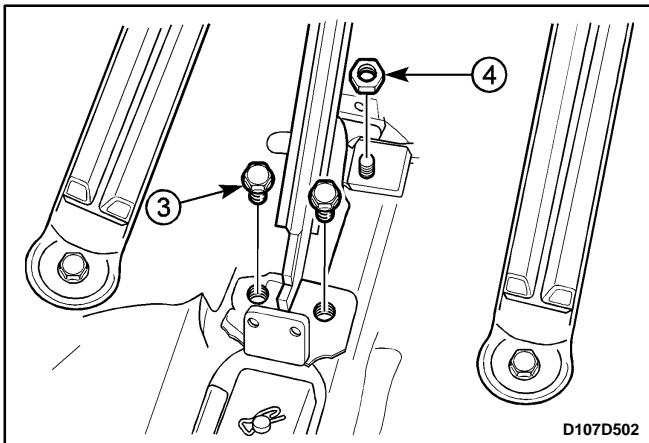

- Remove the bolts (3).
- Remove the nut (4).

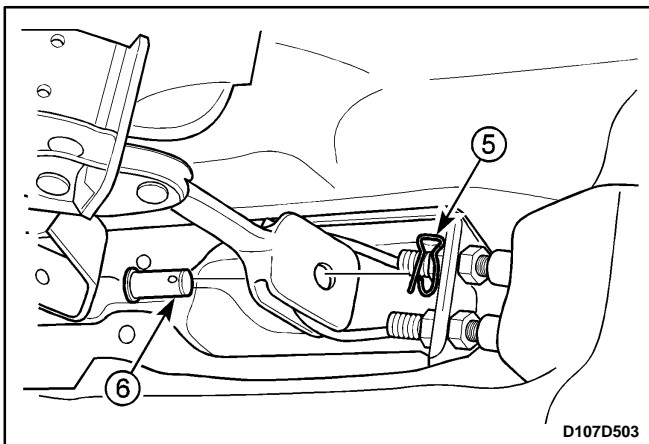

- Remove the cotter pin (5).
- Remove the pin (6).

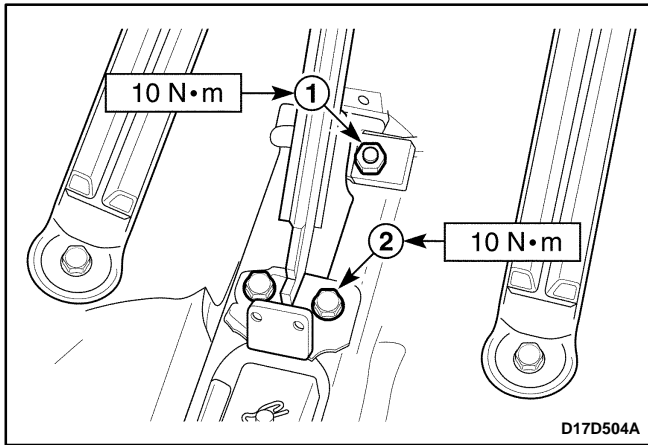

Installation Procedure

1. Install the parking brake lever with the cotter pin, pin, bolts, and nut.

Tighten

- Tighten the parking brake nut to 10 N·m (89 lb-in) (1).
 - Tighten the parking brake bolts to 10 N·m (89 lb-in) (2).
2. Connect the brake warning lamp switch.
 3. Install the brake warning lamp switch screw.
 4. Install the parking brake cable cover. Refer to *Section 9G, Interior Trim*.
 5. Install the parking brake lever cover. Refer to *Section 9G, Interior Trim*.

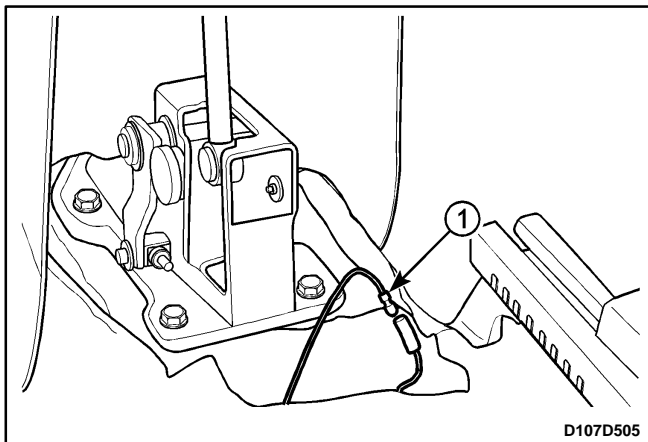

PARKING BRAKE WARNING LAMP SWITCH

Removal Procedure

1. Remove the gear shift lever cover. Refer to *Section 5B, Five-Speed Manual Transaxle*.
2. Remove the parking brake warning lamp switch.
 - Disconnect the parking brake warning lamp switch (1).

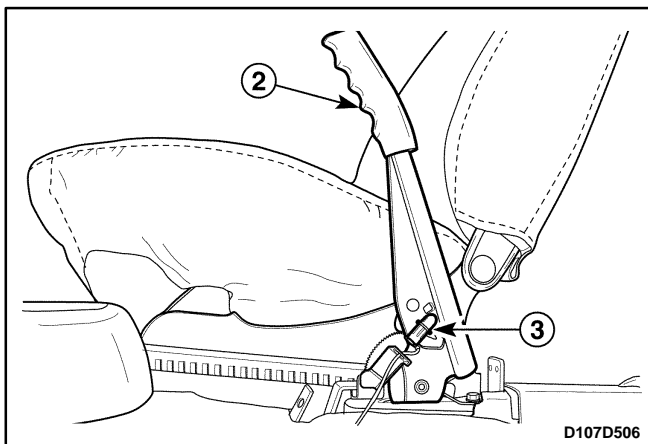

- Apply the parking brake (2).
- Remove the parking brake warning lamp switch carefully (3).

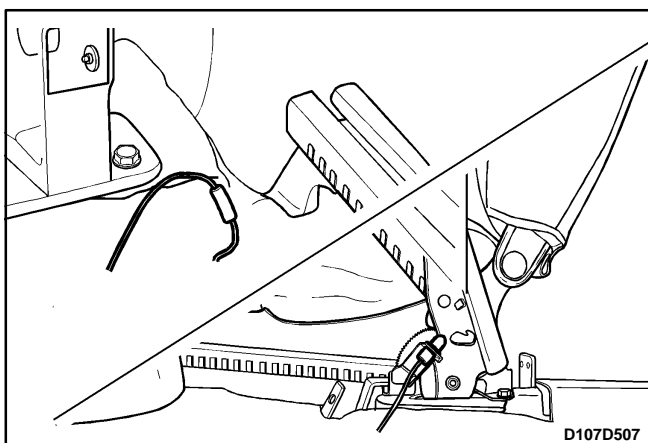

Installation Procedure

1. Install the parking brake warning lamp switch.
2. Release the parking brake.
3. Connect the parking brake warning lamp switch.
4. Install the gear shift lever cover. Refer to *Section 5B, Five-Speed Manual Transaxle*.

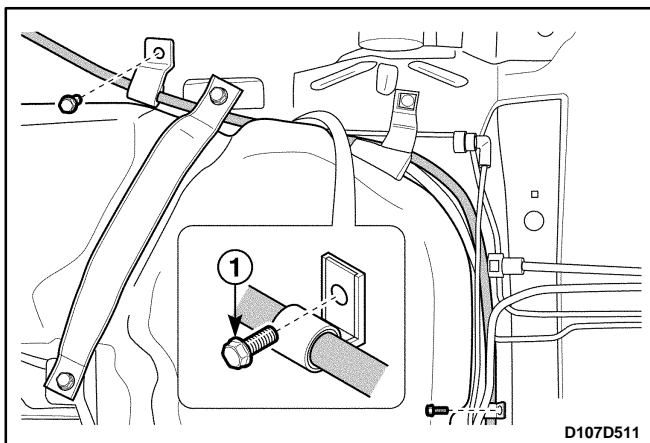
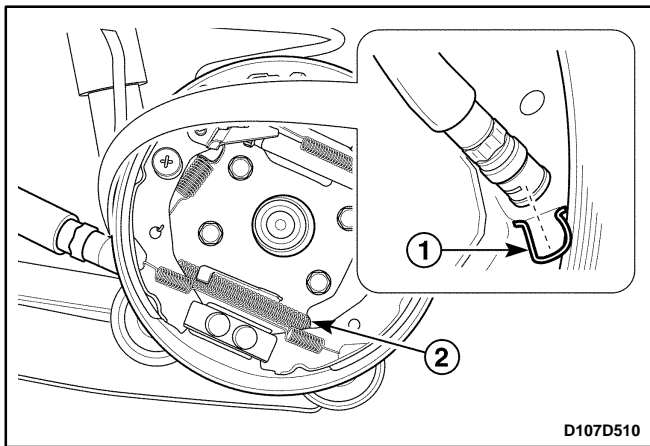
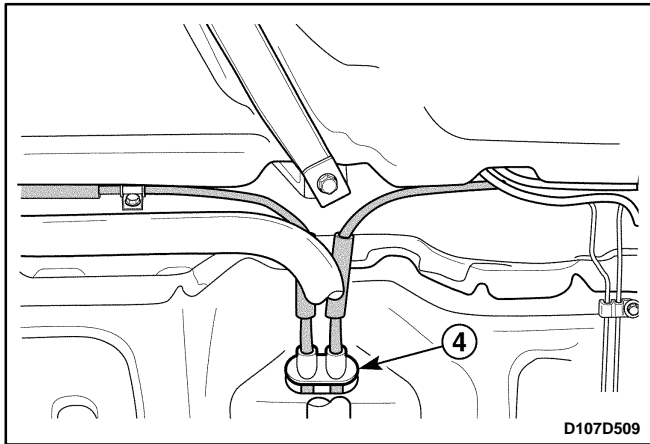
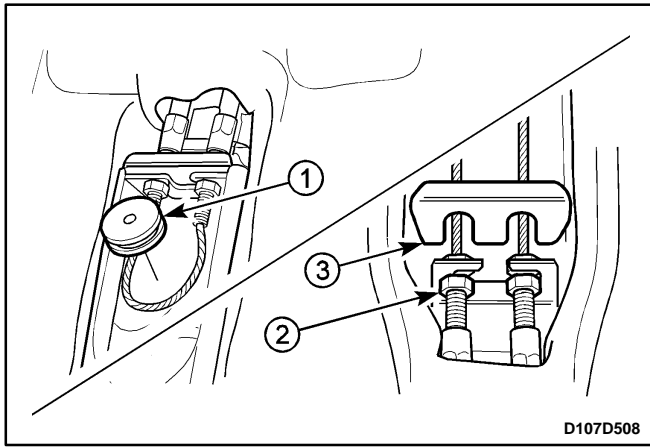

PARKING BRAKE CABLE

Removal Procedure

1. Remove the parking brake lever. Refer to "Parking Brake Lever" in this section.
2. Remove the parking brake cable.
 - Remove the cable pulley (1).
 - Loosen the adjustment nuts (2).
 - Remove the strengthener (3).
- Remove the grommet (4).
3. Remove the rear brake drum assembly. Refer to *Section 2D, Rear Suspension*.
4. Disconnect the parking brake cable from the rear brake drum assembly.
 - Remove the clip from the brake plate (1).
 - Disconnect the parking brake cable from the trailing shoe (2). Refer to *Section 4E, Rear Drum Brake*.
5. Remove the parking brake cable.
 - Remove the clamp bolts fastening the brake cable (RH Rear Brake Side) (1).
 - Remove the fuel filter. Refer to *Section 1F, Engine Controls*.

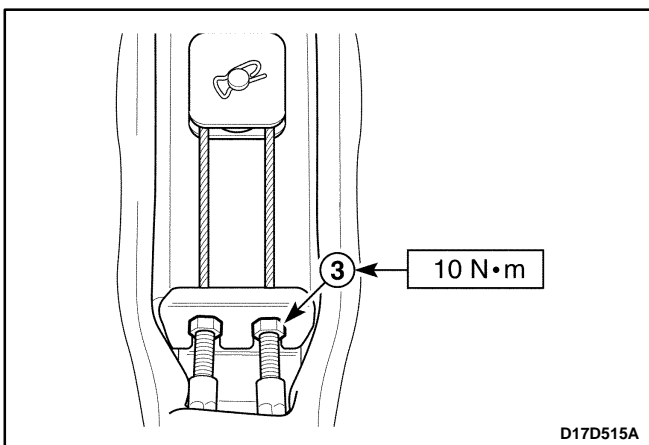
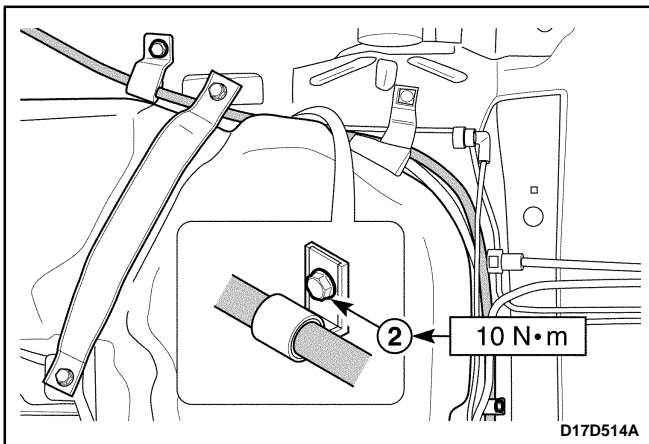
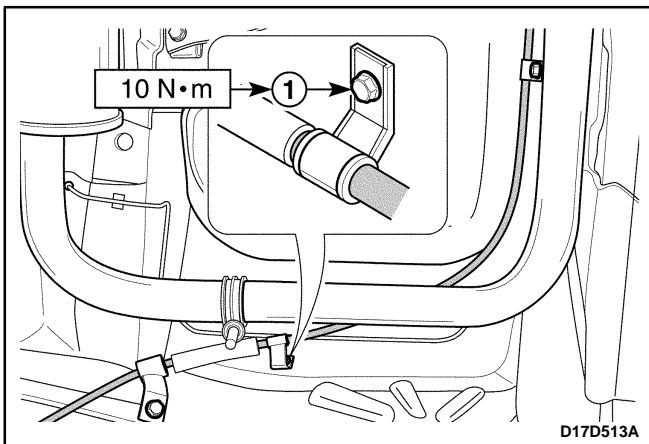
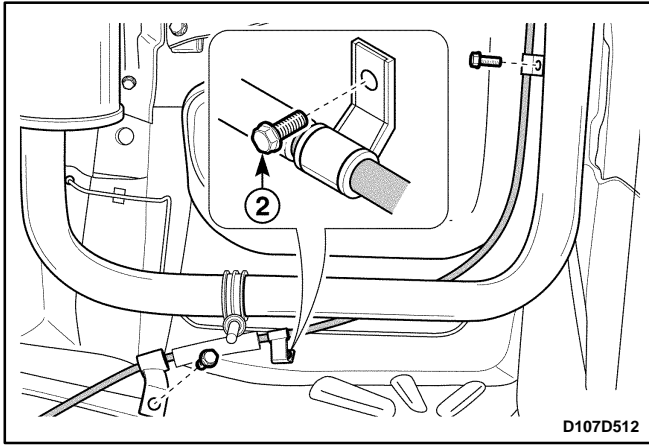

- Remove the clamp bolts fastening the brake cable (LH Rear Brake Side) (2).

Installation Procedure

1. Install the fuel filter.
2. Install the parking brake cable with the clamp bolts.

Tighten

Tighten the parking brake cable clamp bolts to 10 N·m (89 lb-in) (1, 2).

3. Connect the parking brake cable to the rear brake drum assembly. Refer to *Section 4E, Rear Drum Brake*.
4. Install the rear brake drum assembly. Refer to *Section 2D, Rear Suspension*.
5. Install the grommet and the strengthener.
6. Install the cable pulley with the adjustment nuts.

Tighten

Tighten the adjustment nuts to 10 N·m (89 lb-in) (3).

7. Install the parking brake lever. Refer to "Parking Brake Lever" in this section.

SPECIFICATIONS

GENERAL SPECIFICATIONS

Application	Description
Parking Brake Lever Notch Number	5-7 (Loaded 44.1 lb)

FASTENER TIGHTENING SPECIFICATIONS

Application	N•m	Lb-Ft	Lb-In
Parking Brake Cable Clamp Bolts	10	-	89
Parking Brake Lever Bolts	10	-	89
Parking Brake Lever Nut	10	-	89
Parking Brake Cable Adjusting Nuts	10	-	89

SCHEMATIC AND ROUTING DIAGRAMS

PARKING BRAKE SYSTEM

